

Surface Preparation



Surfaces to which the material will be applied must be thoroughly cleaned from dust, grease or any contamination that could affect the adhesion of the material.



Complete a second cleaning using mild soap and water to ensure the window is completely clean.



Finally, rinse with water only and thoroughly dry the surface.

Use a Dry Application Method



Remember when installing material on the inside of a window, the design is applied facing the glass.



Apply dry using a plastic applicator with a low friction sleeve. Avoid touching the adhesive, especially at the edges and corners. Cut away the top 25-50mm of the liner.



Begin application of material on the window.



Start at the top using a core to maintain tension.



Remove the liner at a slow steady pace as you work down. Take care not to stretch the graphics.



Cut the graphics back from the edge of the window by 1-3mm to ensure reliable edge adhesion.

Completion



Complete a final squeegee taking particular care with the edges.



The graphic should not be washed within 24 hours of application to allow the adhesive to reach a sufficient strength.

Joins



Use a butt joint, not an overlap joint.
Tape the first panel onto the glass.



Position the second panel to overlap, align the design and
fix in place.

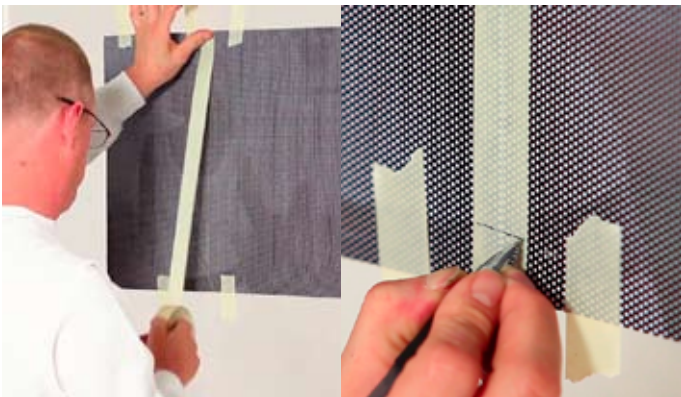

Apply tape along the overlap. Mark with horizontal lines.

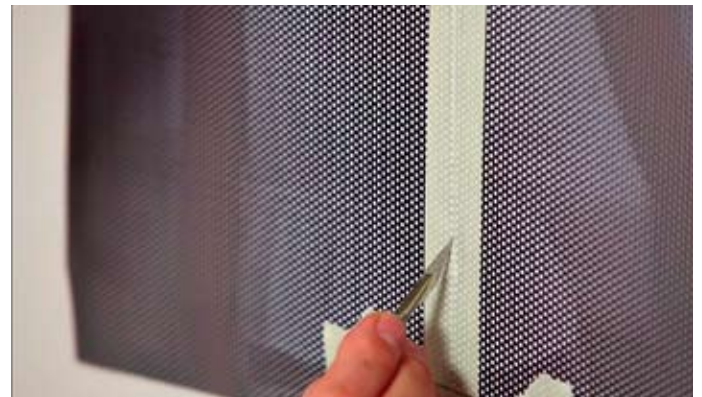

Cut down the centre of the tape, making sure not to cut through
the panels, and remove positional tape.



Apply the first panel.



Position the second panel, aligning horizontal markers,
and fix in place.



Apply the top 25-50mm of this panel.

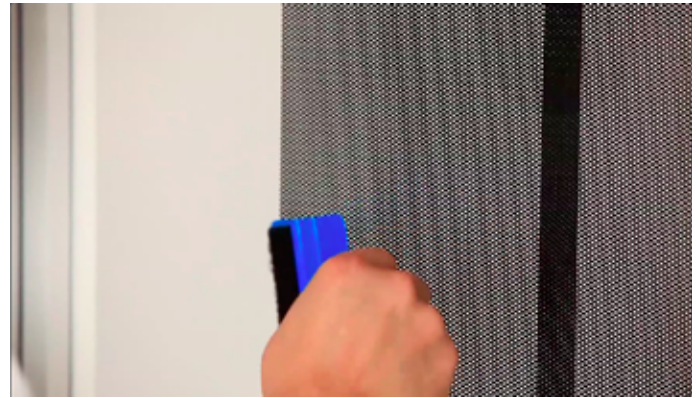

Remove all tape and apply remainder of second panel.

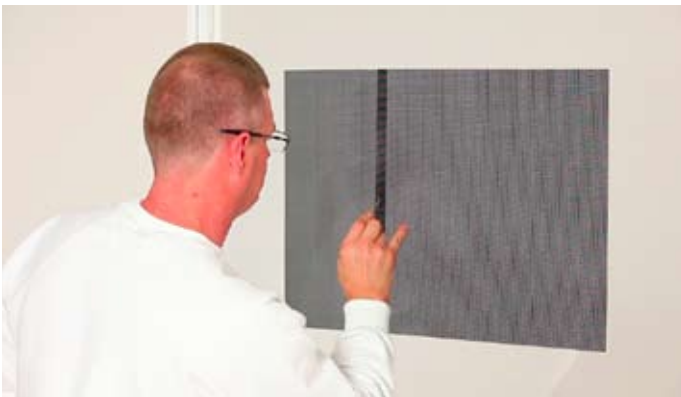

Cut down the centre of the overlap, through both layers of material taking care not to scratch the glass.

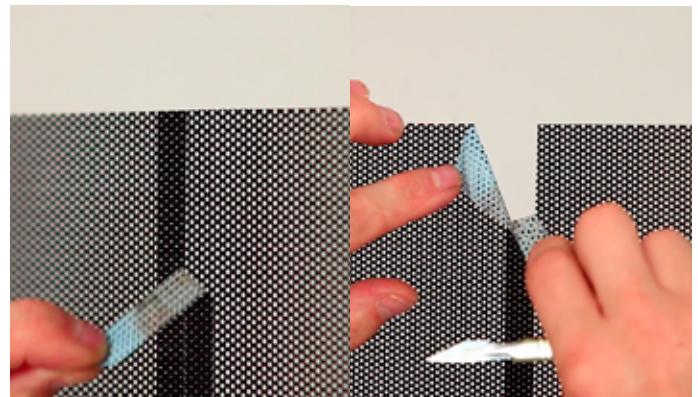

Remove the trimmed excess material to form a clean butt joint.



In summary

- clean your surface thoroughly
- use a dry application method
- remove the liner with care
- avoid touching the adhesive
- don't wash the graphics for 24 hours
- butt joint, don't overlap join