



ARCHITEXTURAL™

Surface. Designed.

INSTALLATION

COVER STYL'

COVER STYL' INSTALLATION

TOOLS

- Sandpaper
- Brush, Spatula
- Squeegee
- Heat gun
- Measuring tape/ruler and cutting knife
- Cutting ruler (straight and round one)
- Soapy water or alcohol based cleaner
- Proprietary Primer (PVA)

PREPARATION

- PRIMER is required for some surfaces.
- All surfaces should be thoroughly cleaned and free from dust and grease before application of COVER STYL'® films. Consider the use of soapy water or degreasing agent. Ensure all surfaces are dry.
- The surface to be covered should be sanded and smooth prior to the application process.
- If necessary, rinse and dry the surfaces to be treated.
- It is recommended that all new plaster work should be left to dry for a period of 3 weeks prior to application of COVER STYL'® films.
- Application to synthetic materials or some painted surfaces may result in a surface reaction "bubbling". It is therefore recommended that a compatibility test be carried out on such surfaces.
- A 20cm X 20cm test piece should be applied and left for 1-2 weeks to ensure no surface reaction occurs.

Preparation

Before you start, it is important to ensure that the work area is clean (dust free) to prevent particles to become attached to the adhesive side of COVER STYL'®. It is recommended to protect the floor around the surface to be treated. Do not apply COVER STYL'® films if the temperature is below 12°C. The ideal application temperature is between 15 and 25°C.

Flat Surface Installation

- Pre cut the Cover Styl' material to the required lengths allowing 50mm extra to the cut sizes.
- Peel 100mm of the protective backing by bending the side and slowly start applying from the top (Dry installation)
- Be careful to ensure correct alignment of the film (vertical patterns or lines)
- As you install the film, press/rub it with the scraper/spatula working in a vertical motion. The squeegee should be held at a 45° angle.
- Once the first 100mm are positioned correctly remove the protective backing from the next 200-300mm and continue the smoothing action until the bottom is reached.
- Once this application process is complete squeegee the surface once more time with a soft cloth applied over the squeegee. Ensuring no air bubbles are evident. Where small pockets of air are visible the surface should be pierced with a small needle to remove the trapped air. Re squeegee the area in question to ensure a smooth finish.

Equipment and tools for fitting the COVER STYL'®

Essential equipment

In addition to the standard tools, the following accessories are indispensable for the application of COVER STYL'® films

- Squeegee (hard plastic) for flat surfaces
- Blue squeegee (soft plastic) for 3D surface
- A knife with replacement blades to cut the protective paper
- Wide metal spatula
- A standard heat gun for softening the film for shapes and contours

Seal

- All panels should be overlapped by 50mm. The overlap should then be cut using a fine blade and rule as shown in the diagram.

Corners Curvers

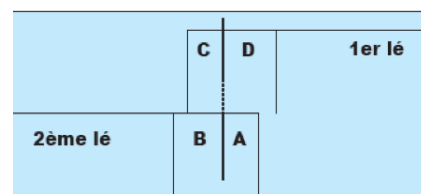

- Once cut remove overlap "A" and discard.
- Lift flap "B" and remove overlap "C" to discard.
- Gently remove the paper liner from the top of "D" and smooth the edges together with "B" using the Squeegee to ensure a smooth finish to both edges. Work both "B" and "D" to the cut edge, a slight rotational movement should be used from top to bottom to ensure a perfect finish.
- Use the technique above but utilize a hair dryer or heat gun between 60 to 65°C. This heat will improve the flexibility of the COVER STYL'® film to ensure the desired curve or corner is obtained.
- Heat the whole piece of COVER STYL'® film working from one side to the other

Columns

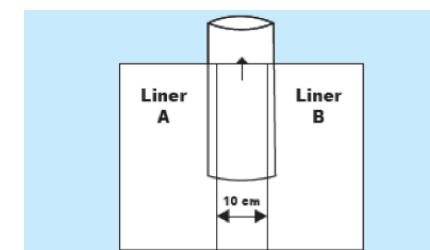

- In order to apply the Cover Styl' film vertically to the column we recommend that a central strip of the backing 100mm wide is removed from the cut length.
- Once this is positioned correctly work outwards on liners "A" and "B" using the correct tools to ensure a smooth finish is obtained peeling back the liner as you work.
- The instructions for obtaining the perfect seal should be followed once the column is completely covered.

COVER STYL'® INSTALLATION

Optional equipment:

- 5 or 10m tape measure.
- Extension lead.
- Disposal brushes (if need to use a primer).
- White cotton rags (for cleaning).
- Various grades 100-180 Sandpaper (to get the surface as smooth as possible).
- Primer/Primer Plus (only if necessary)
- Solvent (for cleaning methyl ethyl Ketone surfaces).

SURFACE PREPARATION

Before cleaning, it is recommended to use a wide metal scraper on the surface to remove loose particles and debris.

First check that the surface is dry and in good condition. Any grease or other dirt must be removed with a suitable solvent. Check the suitability of the surface that is to be covered. To do this, use a small piece of COVER STYL'® on an inconspicuous area. Wait a few minutes, remove the test strip rapidly at an angle of 90° to the surface and check the adhesive side, it should release cleanly. If the treated area is already covered by another coating, make sure it is in good condition and provides good adhesion of the COVER STYL'® film.

Ideally, the surface should be perfectly flat and does not present any protrusions or dents hollow. However, if the surface has irregularities, they should be corrected with filler and/or sanding to prevent them from being visible after the installation of the COVER STYL'®.

PRIMER

For some applications, it is advisable to treat areas with the COVER STYL'® primer. Apply a thin layer of primer on the surface and let dry for a max. 15 minutes.

This will strengthen the adhesion of treated areas. The surface temperature must be min. 10°C.

Please refer to the instructions for use.

When should you use a PRIMER?

COVER STYL'® film should be applied on a clean, smooth, dry, non-porous surface. To optimize grip, use the "Primer" for the following cases:

COVER STYL'® PRIMER

Suitable for use on absorbant surfaces including MDF, plaster and Gypsum.

COVER STYL'® PRIMER "PLUS"

Can be applied to all surfaces. For angles, corners, joints, areas where you need to stretch or shrink the film, overlaps or areas where the film might peel.

The COVER STYL'® film installation can be performed directly after application.

Note

Some materials are more absorbent than others and will require more Primer.

INSTALLATION OF COVER STYL'® FILMS ON PANELS OR WALLS

If the surface is solid, such as steel, stainless steel, glass or laminate, COVER STYL'® films can be repositioned several times to achieve perfection. But if it is a fragile surface, like a paint coat or plaster board, it is essential to place the film in the correct position the first time. Repositioning could damage the surface being treated.

Cuts and measures

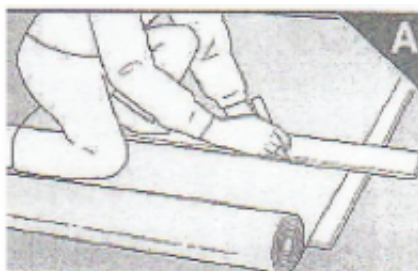

- Measure the application surface
- Identifying the location of the joint
- Work on a flat work surface, for example table, floor, etc.
- Ensure that the working area is clean
- Cut the COVER STYL'® film 3 to 4 cm larger than the application surface, film excess will be cut

Application of the film on the support

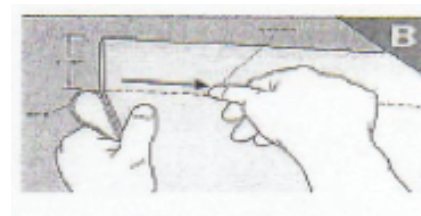

Fold the protective layer on the back of 5 to 10cm using the cutter to cut the protective film paper film place the COVER STYL'® film on the application surface and use a slight thumb pressure in base to fix the film.

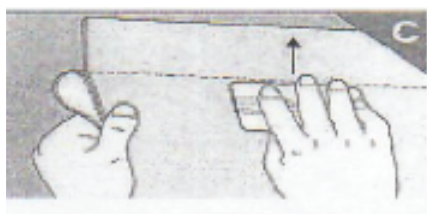

Start from the middle and work on both sides, apply a firm pressure with the squeegee along the folded protective paper. Apply this film section in an upward move from the middle of the film towards the edges.

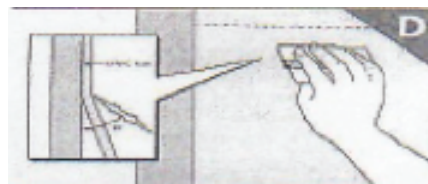

Tilt the squeegee at 45° to the supporting surface, overlap squeegee paths to ensure that all of the surface has been covered which will prevent air bubbles getting trapped under the film.



NOT Peeling off the cover will prevent the contact of the adhesive on the surface, retain some tension on the film starting from the top downwards, use firm squeegee passages and overlap.
Repeat these passages until the entire film is applied.
At the end, re-squeegee firmly all of the edges.

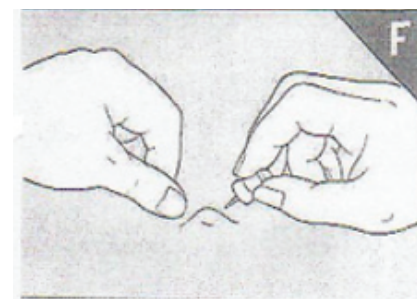

With the COVER STYL'® film, it is not necessary to drill the bubbles so that the air escapes. Cut the film excess with a cutter and a straight rule.

Cuts Straight On The Joints

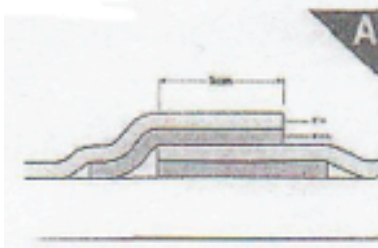

Cut with the cutter without removing the release paper while installing. Apply both layers one on the other with the protective strip.
IMPORTANT! For cutting straight on the joints, it is necessary to place the blade at 90° when cutting, so that the edges of the film meet exactly and do not overlap.

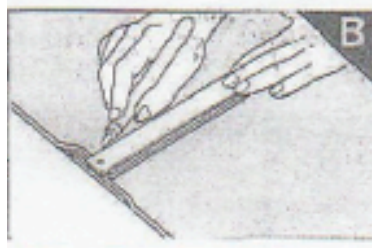

Cut the two films



Remove the film and the release liner



Apply the joint edge to edge

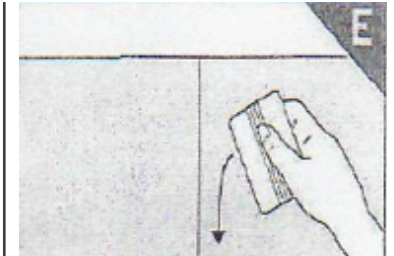

Apply with a squeegee

Application to outside corners



Apply PRIMER "PLUS" on a strip of 4 cm from the corner.
 This will improve the adhesion of the film around the corner.



Apply COVER STYL® when a surface is flat, starting with the largest area. Leave a strip of protective paper in the small vertical strip. To cut the liner, use the cutter.

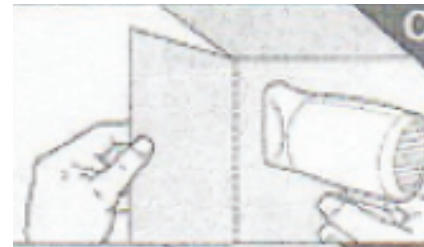

Slightly tension the film when applying around the corner (this avoids bubbles).
 Apply gently while heating along the whole corner if the temperature is below 20 °C.
 Caution excessive heat will stretch and twist the film.

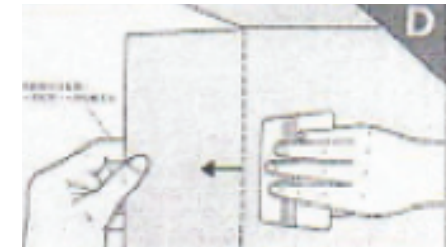

Application to inner corners

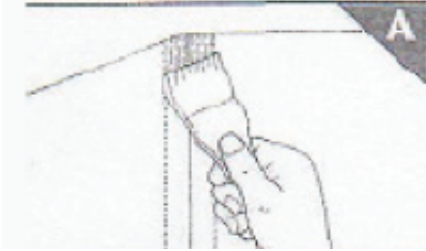

Apply PRIMER "PLUS" on a strip of 4 cm from the corner.
This will improve the adhesion of the film on the corner.



Measure and cut the backing paper accordingly to the corner.
Use the cutter

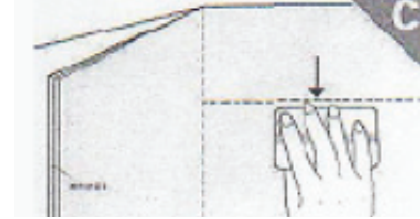

Apply the film over a wide area, for flat surfaces.
Keep the protective paper (not applied) on the vertical strip.

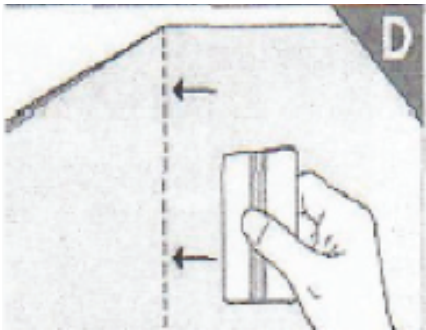

Mark the wedge angle along the length of the panel with the squeegee.
Gradually remove the protective paper from 20 to 30 cm and apply the panel starting from the angle.

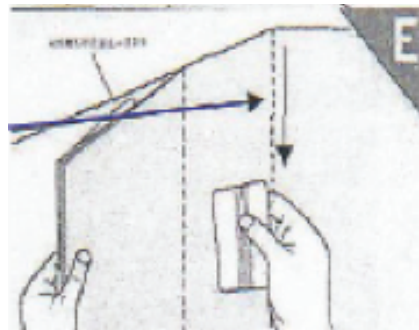

Re-apply with a squeegee on the edges of the film as well as the wedge angle. Cut the film into the corner.



HOW TO REMOVE A COVER STYL'® FILM?

1. Using a sharp knife, score bands of ± 20 cm wide to facilitate the removing of the film. Be careful not to cut too deeply at risk to damage the original untreated surface.
 2. With a heat gun, heat the film strip (from up to down) to “soften” the adhesive and remove each band. Reactivation by heat allows the glue to be removed more easily and moreover it will prevent damage.
 3. Any adhesive residue may be removed from the surface with hot soapy water or isopropyl alcohol.
-



ARCHITEXTURAL™

Surface. Designed.

01833 690305
info@architextural.co.uk
www.architextural.co.uk

 @_Architextural
 @WilliamSmith1832

William Smith Group 1832 Grove Works Queen Street Barnard Castle DL12 8JQ

PART OF **WILLIAM SMITH GROUP 1832**

